

FRCCMAN Manual Clamping Element

- Simple and reliable, this clamping element is manually controlled.
- By acting on the adjustable locking lever, the contact profiles press with sync on the surfaces of the rail.
- The floating profiles of contact ensure a symmetrical distribution of force on the linear guide.

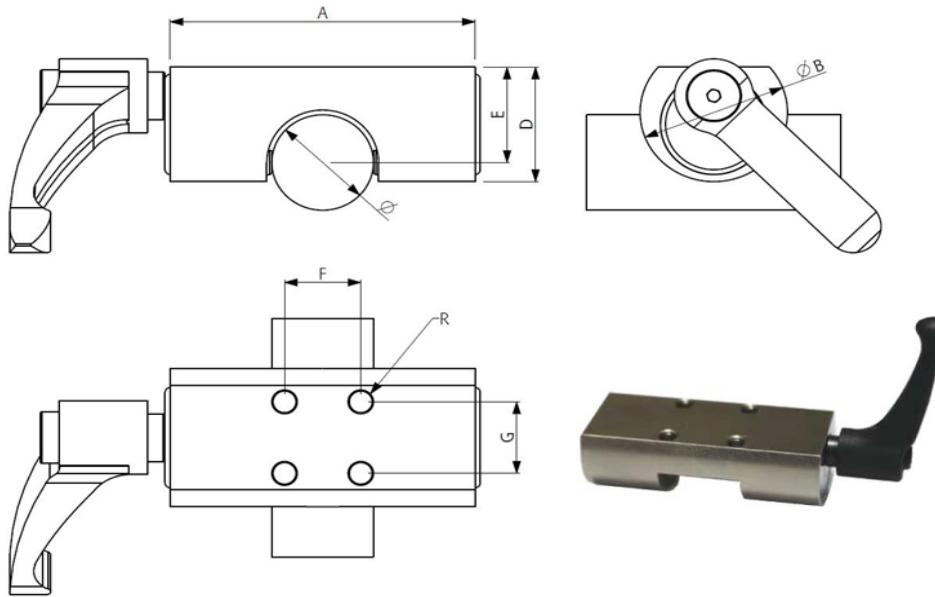

Code	Shaft size ϕ [mm]	Clamping force [N]	A	B	D	E	F	G	R
			[mm]						
FRCCMAN	12	1200	43	30	24	18	17	17	M4x5
FRCCMAN	16	1200	47	30	26	22	17	17	M4x5
FRCCMAN	20	1200	60	32	28	25	15	15	M5X6
FRCCMAN	25	1200	70	40	36	30	18	18	M6x8
FRCCMAN	30	2000	90	45	41	35	20	20	M6x8

Table 1. Table of manual clamping element selection (mm dimensions).

Ordering information

