

# Wide Guide Rails R0455

For runner blocks R0443 and R0441  
 Mounting hole pattern, size 9/M3, 12:  
 – single row  
 Mounting hole pattern, size 15:  
 – double row  
 Guide rails are made of rust and acid resistant material similar to ISO 683-17 / EN 10088.

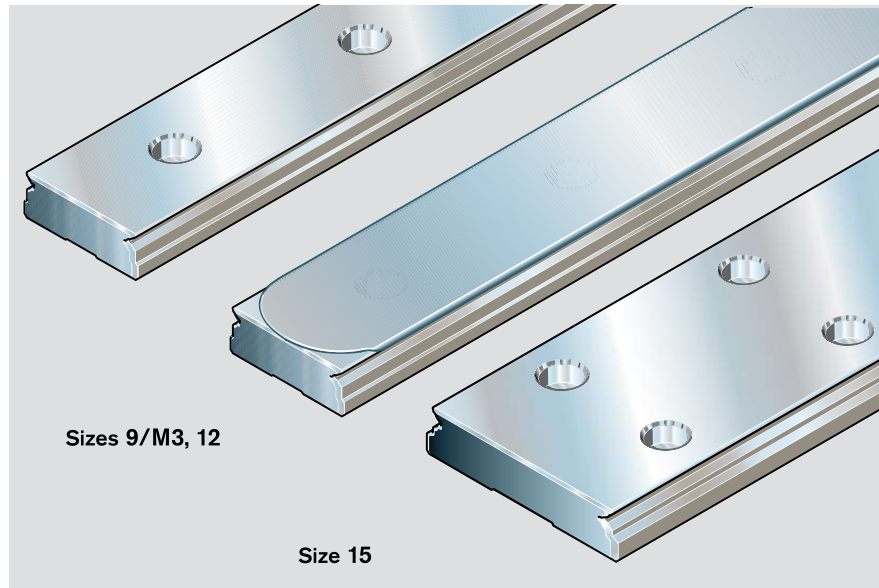

## Part numbers for guide rails

Size	Accuracy class	Part numbers for wide guide rails	
		Part number, length L (mm)	
		without cover strip	with cover strip
9/M3	P	R0455 802 31,....	R0455 862 31,....
	H	R0455 803 31,....	R0455 863 31,....
	N	R0455 804 31,....	R0455 864 31,....
12	P	R0455 202 31,....	R0455 262 31,....
	H	R0455 203 31,....	R0455 263 31,....
	N	R0455 204 31,....	R0455 264 31,....
15	P	R0455 502 31,....	R0455 562 31,....
	H	R0455 503 31,....	R0455 563 31,....
	N	R0455 504 31,....	R0455 564 31,....

## Recommended rail lengths

$$L = n_B \cdot T - 4$$

L = rail length (mm)  
 T = hole spacing (mm)  
 n<sub>B</sub> = number of holes per row

## Ordering Examples

☞ If no T<sub>1</sub> is specified by the customer, both ends of the guide rail will be identical. The rail lengths were calculated using the formula for recommended rail lengths.

### Ordering example 1

(up to L<sub>max</sub>):

Guide rail size 12, accuracy class P, recommended rail length 836 mm (20 · T, number of holes n<sub>B</sub> = 21, T<sub>1</sub> is identical at both ends of the guide rail)  
 Ordering data: **R0455 202 31, 836 mm**

### Ordering example 2

(up to L<sub>max</sub> with cover strip):

Guide rail size 9/M3, accuracy class H, recommended rail length 926 mm (30 · T, number of holes n<sub>B</sub> = 31, T<sub>1</sub> at one end of guide rail = 4.5 mm)  
 Ordering data:

**R0455 863 31, 926 mm, T<sub>1</sub> = 4.5 mm**  
 (At the other end of the guide rail T<sub>1</sub> = 21.5 mm for production reasons)

### Ordering example 3

(composite rail over L<sub>max</sub>):

Guide rail size 15, accuracy class N, recommended rail length 1436 mm, 2 sections (35 · T, number of holes n<sub>B</sub> = 36 per row, T<sub>1</sub> is identical at both ends of the composite guide rail)  
 Ordering data: **R0455 504 32, 1436 mm**

Number of sections ———┐

### Ordering example 4

(one-piece over L<sub>max</sub>):

Guide rail size 12, accuracy class P, recommended rail length 1636 mm (40 · T, number of holes n<sub>B</sub> = 41, T<sub>1</sub> is identical at both ends of the guide rail)  
 Ordering data: **R0455 202 31, 1636 mm**

## Dimensions and weights

### Sizes 9/M3, 12

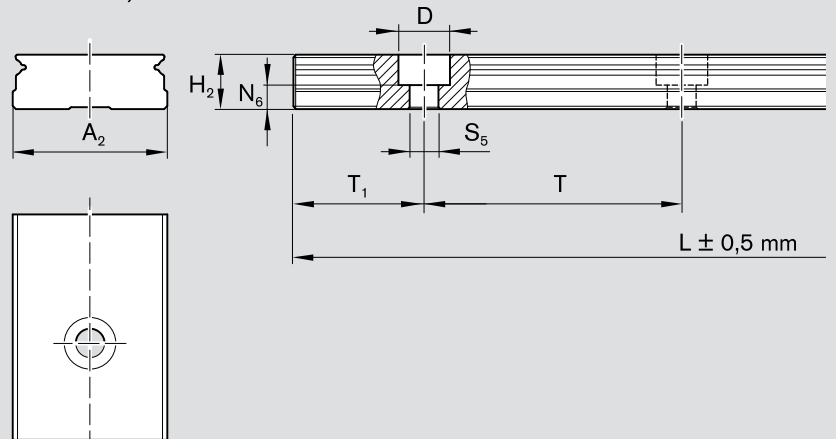

### Size 15

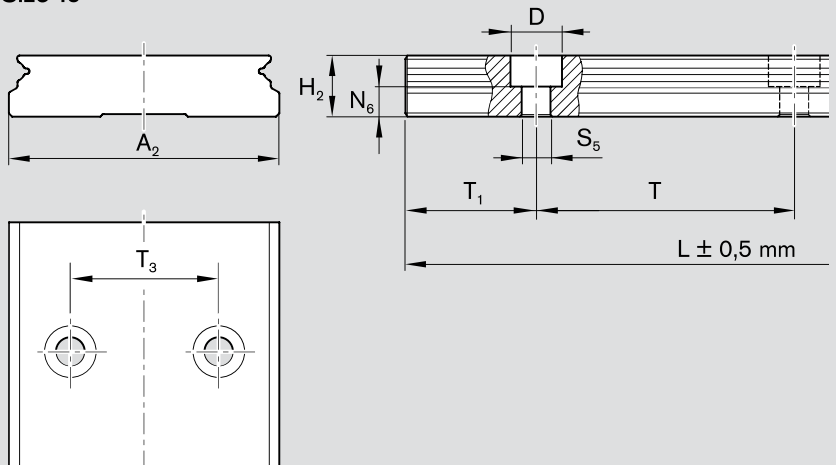

Position tolerance of the mounting holes for

$$L < 500 \text{ mm} \quad \begin{matrix} \oplus \\ \ominus \end{matrix} \quad \text{Ø } 0.3$$

$$L < 1000 \text{ mm} \quad \begin{matrix} \oplus \\ \ominus \end{matrix} \quad \text{Ø up to 0.6 increasing in linear proportion}$$

Size	Dimensions (mm)										Weight (g/100 mm)
	A <sub>2</sub>	H <sub>2</sub> <sup>1)</sup>	N <sub>6</sub>	D	S <sub>5</sub>	T <sub>1min</sub>	T <sub>1max</sub>	T	T <sub>3</sub>	L <sub>1max</sub> <sup>2)3)</sup>	
9/M3	18	7.5	2.7	6.0	3.5	6.0	25.5	30	-	1000	92
12	24	8.5	3.7	8.0	4.5	6.0	34.5	40	-	1000	145
15	42	9.5	4.7	8.0	4.5	6.0	34.5	40	23	1000	286

1) Dimensions without cover strip

2) For rail lengths longer than L<sub>max</sub> factory-made mating sections are joined end-to-end.

3) For special cases one-piece guide rails up to 2000 mm length possible (please ask).